

What's in the box

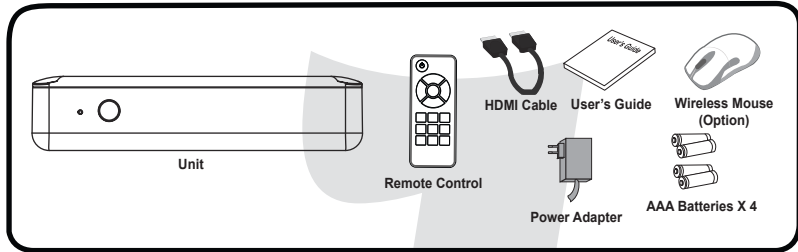

Connection & Name

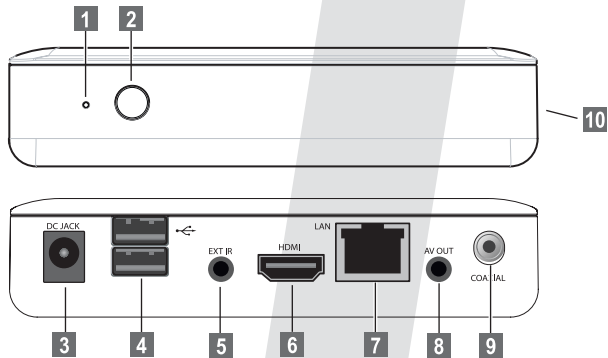

- | | |
|--|---|
| <p>1 Power LED</p> <p>2 IR receiving part To receive IR signal from remote control</p> <p>3 DC IN (12V) To Connect Power Adapter cable</p> <p>4 USB HOST Digital Input jack for USB Storage (USB external HDD or USB memory) It can be used for Wireless Option.</p> <p>5 EXTERNAL IR To connect external IR receiver</p> | <p>6 HDMI OUT To Connect to HDMI input of TV</p> <p>7 LAN To Connect to LAN cable</p> <p>8 AV OUT To Connect to Audio Video Input of TV</p> <p>9 COAXIAL To Connect to Coaxial Input of Digital Amplifier</p> <p>10 SD Card Slot To connect SD Memory Card</p> |
|--|---|

CE This product is in conformity with the EMC directive and low-voltage directive.



Input Device

1 Mouse - Wireless (Option)

1. Connect wireless USB in the battery compartment of the mouse to an USB input of this unit. Turn on the mouse by on/off button at the bottom.



- 1 Left Button**
 - Click : You can activate the action where cursor is located.
 - Long Click : You can grab the apps for move or delete. You can select and activate further actions such as copy, paste, move, delete, download and select input methods.
- 2 Scroll Button**
 - Click : It works as RETURN that you can go back to the previous screen or exit from where you are.
 - Scroll up : You can move up to the list or to the page.
 - Scroll down : You can move down to the list or to the page.
- 3 Right button**
 - You can enter the setting menu of the current application for adjusting value of each application.

2 Remote Control



- TV SYSTEM TV Resolution Toggle
- Source Selection for media file device
- Home - Going to Wallpaper
- MENU Going to each Application Menu
- Backspace
- Search
- Return - Going Back after setting
- Stand-by / Power On
- Repeat Playback
- Zoom In / Zoom Out
- Skip Backward / Skip Forward Page Up / Page Down in Web page
- Audio Mute
- Going to Movie, Music, Photo Application
- Fast Backward / Fast Forward
- Previous / Next
- Function RED Display File Info during Playback
- Function GREEN Select AUDIO during Playback
- Function YELLOW Subtitle Selection by Pressing Subtitle Setting by Long Pressing
- Function BLUE Toggling Number key and Text Input

VIDEO GUIDE You can find Video Guide with the following steps in T1 when you are connected to Internet.

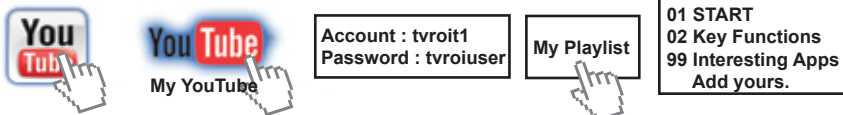

* You can watch all in www.tvroi.net which is multi-language forum and product information page.

Terminology

- ◆ APP : The abbreviation for Application Software.
- ◆ Wallpaper : The Background for Home of this unit. You can add/delete APPs, Widget or Shortcuts on or from it.
- ◆ App Drawer : The drawer where all applications of this unit are stored when you install them.
- ◆ Widget : A single interaction point for the direct manipulation of a given kind of data by an APP such as time and weather.

Basic Setting

1 Language and Keyboard Setting



* You can change language by dragging mouse point on space bar.

2 Display Setting

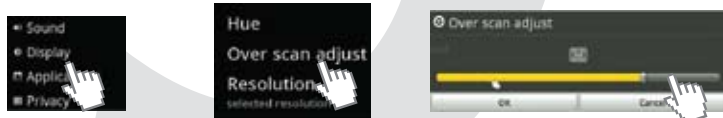

3 Time Setting



4 Network Setting

◆ Ethernet (LAN) Setting

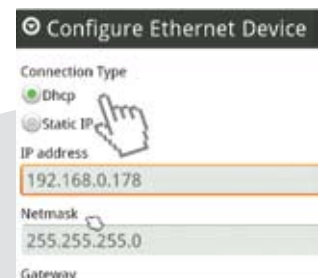

* When you type the IP address, it would be easier to use Remote Control number keys and Blue color function key for dot(.).

◆ Wifi (Wireless LAN) Setting

You need optional wireless USB adapter for this connection which is not included in this package.

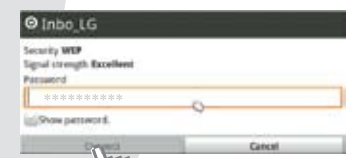

5 Application Setting

Please allow the installation of external APP (APK file) by clicking "Unknown sources".

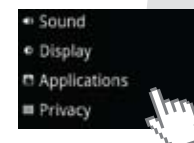

* All trademarks or names or logos shown on this manual are registered trademarks of their respective holders. They are shown only for explanation of their functions.

APP Installation / Uninstallation

1 Installation from Market

This unit has its own market which contains verified APPS. You can download and install them.



Press STOP on Remote Control to EXIT the TVROI Market

NOTE

You may encounter an failure of installation of APPS from Market. Please uninstall it first and try to install it again.

2 External APK File

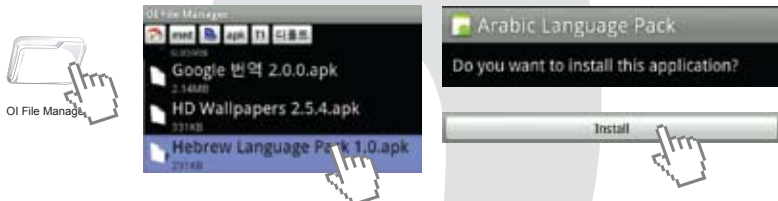

NOTE

Most APK files are mainly for Smart Phone so that many of them are not able to be installed or not to be working correctly in this unit. In case that it is found to be, uninstall it from this unit. Some of APK file could contain computer virus. Please install what is verified only.

3 Uninstallation

Easy Uninstaller

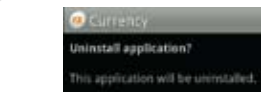
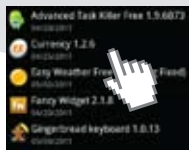

Adding or Deleting APPS on or from Home Wallpaper

All installed APPS will be stored at APP Drawer. You can add them on your Home Wallpaper and take them back to APP Drawer.



Icon for opening App Drawer located at the middle of right end in Home wallpaper.



Home Icon for going back to Home Wallpaper at the middle of right end in App Drawer.



Trash Bin Icon that you can drop down for deleting an App from Home Wallpaper. App Drawer Icon shall change to it when you long click on an App.

1 Adding APPS on Home Wallpaper

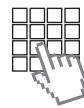

Place the app on the location you want in Home Wallpaper.

Long Click on an App

2 Deleting APPS from Home Wallpaper



The app shall be deleted from Home Wallpaper only while you still have it on App Drawer.

Long Click on an App

Drop it on Trash Bin

F/W Upgrade * You can download the F/W from www.tvroi.net

1 Uninstall all the applications by Easy Uninstaller before F/W upgrade in order to prevent any conflict during re-install them.

2 Copy the F/W upgrade file into the root directory of USB or SD card after unzipping it. Connect USB memory or SD Card which containing F/W Upgrade file into this unit.



Preferences

Restore Backup

YES

Shortcut

You can add the bookmark of your favorite sites or APPS on Home Wallpaper as Shortcuts.

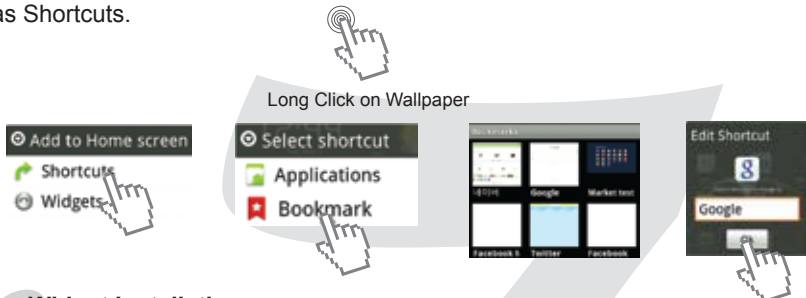

Widget Installation

You can add Widget on Home Wallpaper including Clock, Weather.

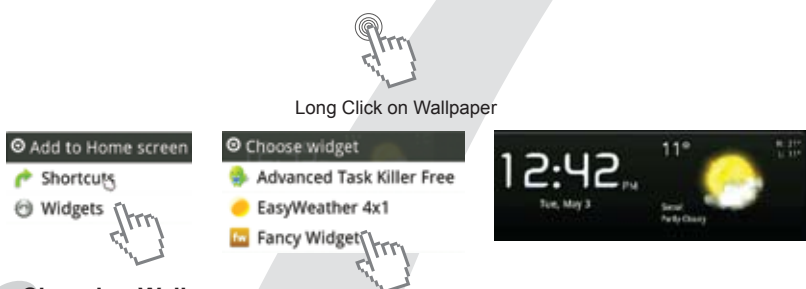

Changing Wallpaper

1 From Wallpaper gallery



Long Click on Wallpaper

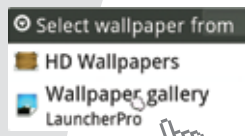

2 With APPS

You can change Wallpaper with APPS such as HD Wallpapers.

* All trademarks or names or logos shown on this manual are registered trademarks of their respective holders. They are shown only for explanation of their functions.

AV File Playback

1 Selecting AV File Source

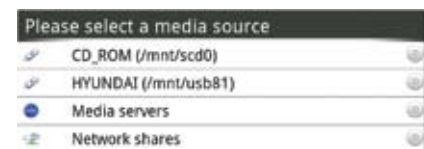

2 AV File Playback



- RED : Display File Info during Playback
- GREEN : Select AUDIO during Playback
- YELLOW : Subtitle
Selection by Pressing during playback
Setting by Long Pressing during Playback

◆ How to enjoy Icon Mode : Copy the photo file (JPG or PNG) into the same folder of Video file location with same name as video file like subtitle file.



◆ How to select background music in Slide Show.

MENU Setting Select Background Music

◆ Slide Show

MENU Slide Show



Shuffle Repeat once Repeat All

◆ The Icon will be shown only for the MP3 file which has album art in its ID3 Tag. Default Icon will be shown only with other files.

* Some of files in above format may not be supported depending on the encoding method. You are kindly requested to make transcoding them with the proper utility program.

NOTE



Most of Android APPS do not have EXIT mode so that they may be active in the background after finishing them which may cause the system delay. Please kill the background working APPS by pressing the task killer app (ex. Advance Task Killer) time to time to secure memory space. It help system working in normal condition.